

1 FOUNDATION REFERENCE PLAN
1/8" = 1'-0"

FOUNDATION PLAN NOTES

1. UNLESS NOTED OTHERWISE, CONCRETE SLAB SHALL BE 8" THICK OVER MASONITE WORK SURFACE, OVER 12" DEEP VOID CARTONS. REFER TO PLANS FOR REINFORCING.
2. SLAB REINFORCING SHALL BE PLACED w/ THE N-S DIRECTION BARS AS THE OUTER MOST LAYER OF REINFORCING:
 - a. PLACE N-S DIRECTION BOTTOM BARS
 - b. PLACE E-W DIRECTION BOTTOM BARS
 - c. PLACE E-W DIRECTION TOP BARS
 - d. PLACE N-S DIRECTION BOTTOM BARS

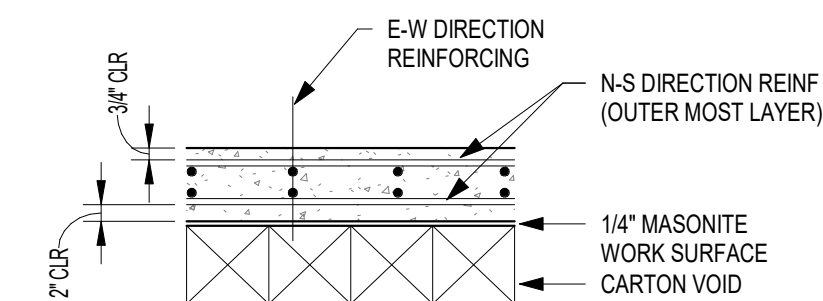

LEGEND:

100.0 INDICATES FINISH FLOOR RELATIVE TO DATUM
100.0 (CIVIL = 645.25)

ARCHITECTURE

SCOTT MARTSOLF - ARCHITECT

410 East 6th Street
Fort Worth, Texas 76102

Phone: (817) 820-0005
Fax: (817) 820-0008

ST. JUDE CATHOLIC CHURCH

PARISH HALL REMODEL & CONNECTOR BUILDING

500 E DALLAS ST.
MANSFIELD, TX 76063

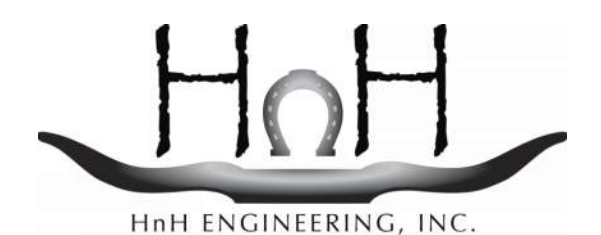

HnH ENGINEERING, INC.

105 Sproles Drive Fort Worth, Texas 76126
TBPE Firm No. F-13825 (817) 713-4977

BID SET

Drawing Title:
FOUNDATION REFERENCE PLAN

Project No.
2023.297

Date:
12/20/2023



Sheet No.
S1.1