

HPA
 ESTABLISHED 1962
 ARCHITECTS PROGRAMMERS PLANNERS
 4724 OLD JACKSBORO HIGHWAY
 WICHITA FALLS, TEXAS 76302-3599
 VOICE: 940.767.1421 FAX: 940.397.0273
 WEB: www.hpa1962.com

FINCHER
 ENGINEERING, LLC
 FINCHER ENGINEERING, LLC
 TX FIRM #F-16408
 5621 114TH ST., SUITE 100
 LUBBOCK, TX 79424
 PH: 806-701-5109
 WWW.FINCHERENG.COM

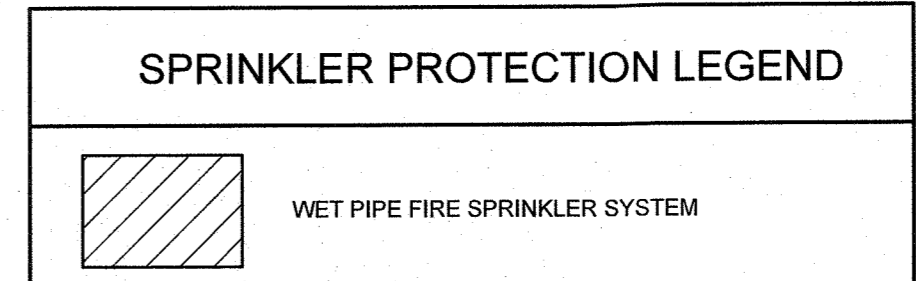

- FIRE SPRINKLER SYSTEM**
- ENTIRE BUILDING SHALL BE PROVIDED WITH A NEW FIRE SPRINKLER SYSTEM INSTALLED ACCORDING TO THE REQUIREMENTS OF NFPA-13 AND ALL APPLICABLE LOCAL CODES.
 - ALL PIPING SHALL BE STEEL PIPING. SIZE 2-1/2" AND LARGER SHALL BE SCHEDULE 10 WITH GROOVED COUPLINGS AND LINES 2" AND SMALLER SHALL BE SCHEDULE 40 WITH THREADED FITTINGS.
 - UTILIZE CONCEALED SPRINKLER HEADS IN ALL LOCATIONS WITH CEILINGS.
 - CONTRACTOR SHALL COORDINATE WITH ALL UTILITY COMPANIES PRIOR TO BID AND INCLUDE ALL COST FOR NEW SERVICE AS REQUIRED FOR A COMPLETE AND OPERATIONAL SYSTEM FOR OWNER.
 - UTILIZE DRY SYSTEM AS REQUIRED TO SERVE NON-HEATED AREAS AND COVERED PATIOS AND OVERHANGS AS REQUIRED BY LOCAL FIRE MARSHAL.
 - ALL SPRINKLER HEADS SHALL BE LOCATED IN CENTER OF CEILING TILES IN ROOMS WITH LAY-IN CEILINGS.
- KEYED NOTES**
- TURN 6" FIRE LINE UP IN ROOM TO FIRE RISER, REFER TO DETAIL.
 - REFER TO CIVIL DRAWINGS FOR CONTINUATION.

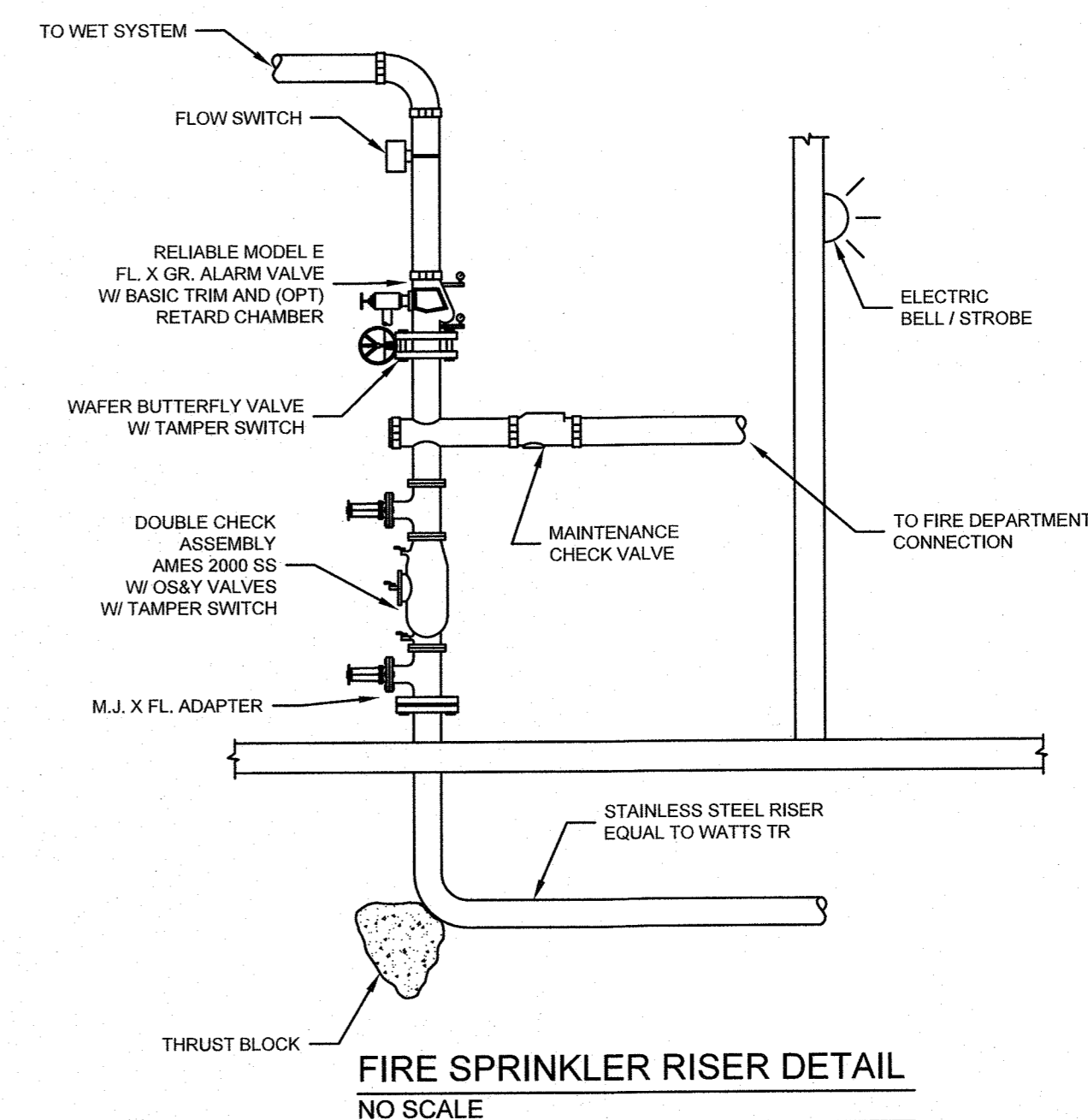
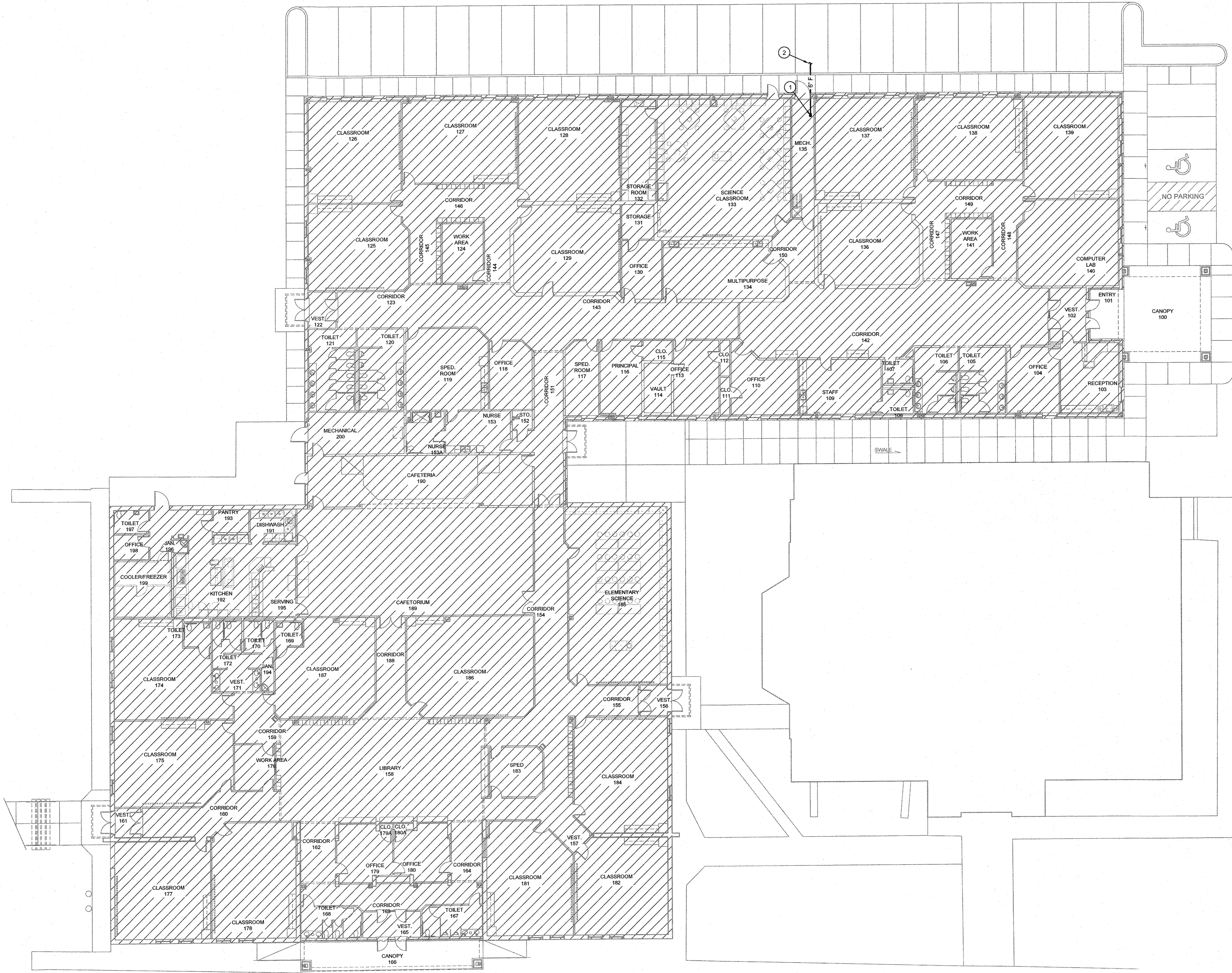

FLOOR PLAN - FIRE SPRINKLER SYSTEM SCALE: 3/32" = 1'-0"

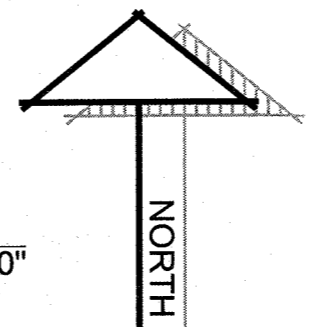

ADDITIONS AND RENOVATIONS TO THE
GORDON I.S.D. CAMPUS
 FOR GORDON I.S.D.

GORDON, TEXAS 76453

112 RUSK STREET

DRAWN BY: FINCHER

DATE: 28 JULY 2022

REVISIONS		
NO.	DESCRIPTION	DATE

PROJECT NO.
20864.00

SHEET NO.
FP101

© HPA INC.

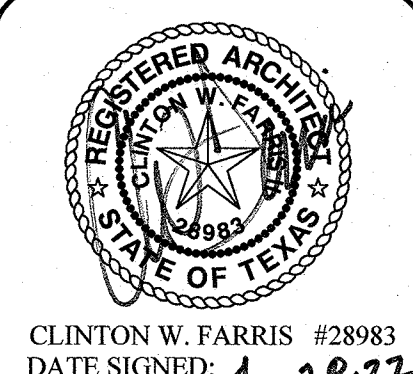

HPA
 ESTABLISHED 1962
 ARCHITECTS · PROGRAMMERS · PLANNERS
 4724 OLD JACKSBORO HIGHWAY
 WICHITA FALLS, TEXAS 76302-3599
 VOICEMAIL: 940.767.1421 FAX: 940.397.0273
 WEB: www.hpa1962.com

FINCHER
 ENGINEERING, LLC
 FINCHER ENGINEERING, LLC
 TX FIRM #F-16408
 5621 114TH ST., SUITE 100
 LUBBOCK, TX 79424
 PH: 806-701-5109
 WWW.FINCHERENG.COM

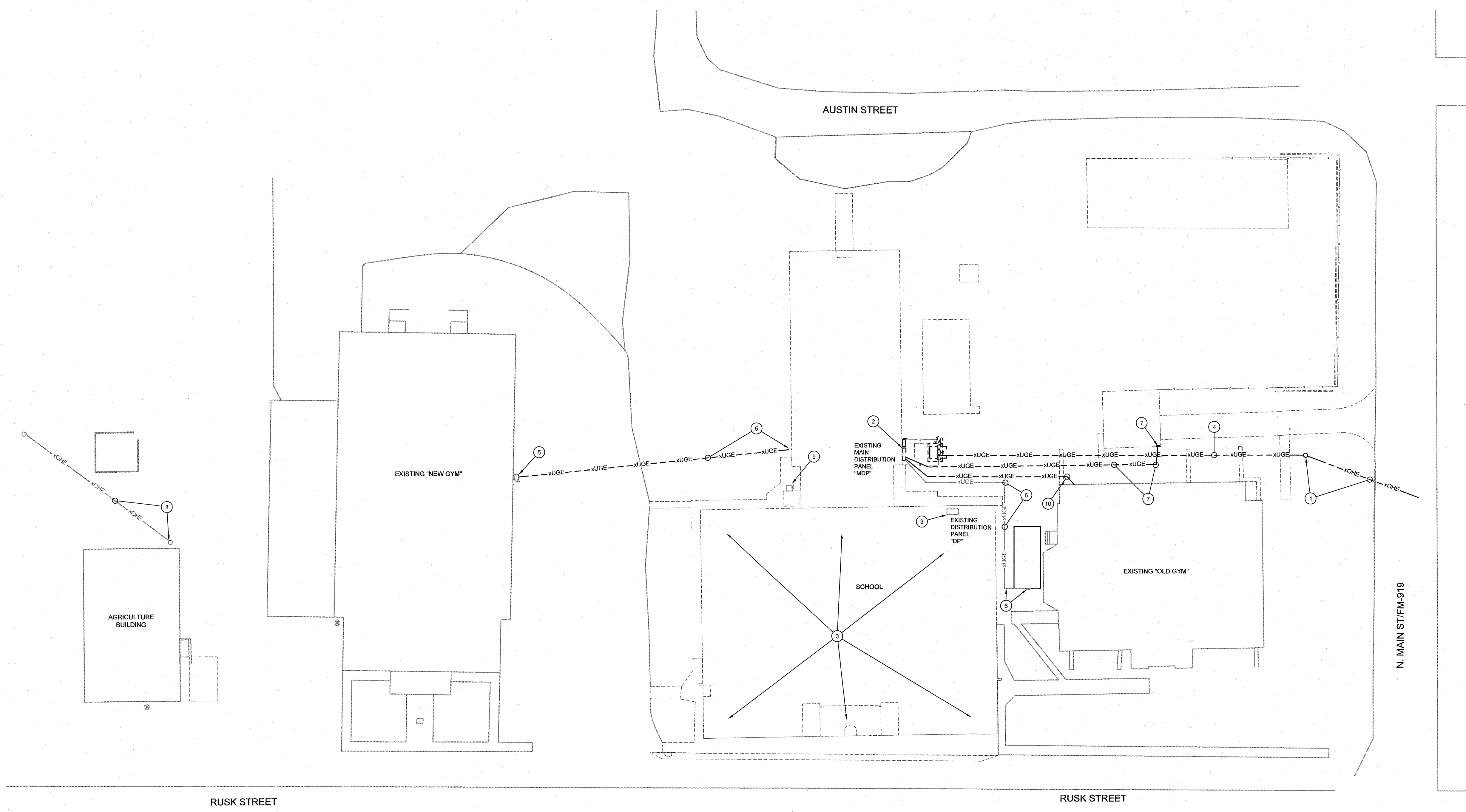

SITE PLAN - ELECTRICAL DEMOLITION

SCALE: 1" = 30'-0"

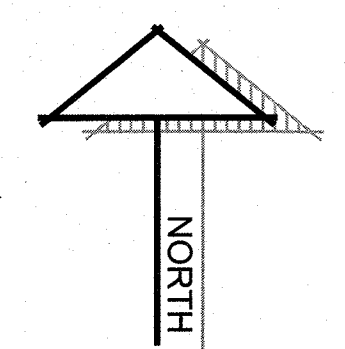

GENERAL NOTES	KEYED NOTES
<p>A. ALL ELECTRICAL DEVICES SHOWN DASHED, OR ON DASHED WALLS, ALONG WITH ALL WIRING AND CONDUIT ASSOCIATED WITH DEVICE SHALL BE REMOVED BACK TO POINT OF ORIGIN UNLESS NOTED OTHERWISE.</p> <p>B. CONTRACTOR SHALL VERIFY LOCATION OF ALL UNDERGROUND UTILITIES PRIOR TO EARTHWORK.</p> <p>C. VERIFY EXACT LOCATION OF ALL DEVICES AND CONDUIT TO REMAIN.</p> <p>D. THE ELECTRICAL CONTRACTOR SHALL VERIFY ALL PANEL CONNECTIONS PRIOR TO PANEL REMOVAL/RELOCATION. THE CONTRACTOR IS RESPONSIBLE FOR EXTENDING AND CONNECTING ALL FEEDER BRANCH CIRCUITS/CONDUITS TO REMAIN. CONTRACTOR SHALL SIZE CONDUCTOR/CONDUIT IN ACCORDANCE WITH NEC.</p> <p>E. ALL DOWNSTREAM DEVICES NOT BEING REMOVED AS PART OF THIS PROJECT SHALL REMAIN ACTIVE. THIS INCLUDES BUT NOT LIMITED TO RECEPTACLES, LIGHTS, FIRE ALARM, DATA, AND COMMUNICATION OUTLETS/WIRING.</p> <p>F. ALL POWER AND COMMUNICATIONS OUTAGES SHALL BE COORDINATED WITH OWNER AND ARCHITECT PRIOR TO OUTAGE. PROVIDE TEMPORARY CONNECTIONS (POWER AND COMMUNICATION WIRING) TO EQUIPMENT TO MAINTAIN SERVICE DURING CONSTRUCTION AS REQUIRED.</p>	<p>1. EXISTING UTILITY POLE AND ASSOCIATED OVERHEAD SERVICE SHALL BE REMOVED. COORDINATE REQUIREMENTS WITH UTILITY COMPANY.</p> <p>2. EXISTING PANEL MAIN DISTRIBUTION PANEL (MDP) SHALL BE REMOVED AND RELOCATED FOR TEMPORARY ELECTRIC SERVICE TO EXISTING SCHOOL BUILDING, EXISTING GYM BUILDING, EXISTING OLD GYM BUILDING AND BATHROOM BUILDING. EXTEND TEMPORARY SERVICE TO EXISTING BUILDING PANEL TO REMAIN AS REQUIRED BY NEC. PROVIDE CONDUITS AND CONDUCTORS AS NEEDED FOR ALL FEEDER AND BRANCH CIRCUITS TO REMAIN. FIELD VERIFY EXISTING CONDITIONS PRIOR TO BIDDING. COORDINATE LOCATION TEMPORARY MAIN DISTRIBUTION PANEL WITH ARCHITECT AND OWNER.</p> <p>3. EXISTING DISTRIBUTION PANEL. ALL ASSOCIATED PANELS IN THIS AREA SHALL REMAIN ACTIVE. COORDINATE PHASING REQUIREMENTS WITH ARCHITECT. PROVIDE TEMPORARY CONNECTION TO MAINTAIN POWER TO THIS SECTION OF THE BUILDING. FIELD VERIFY EXISTING CONDITIONS PRIOR TO BIDDING.</p> <p>4. EXISTING UNDERGROUND PRIMARY UTILITY SERVICE SHALL BE REMOVED. COORDINATE REQUIREMENTS FOR TEMPORARY ELECTRIC SERVICE WITH ARCHITECT, OWNER, AND UTILITY COMPANY.</p> <p>5. EXISTING UNDERGROUND SERVICE TO BE REMOVED. PROVIDE TEMPORARY ELECTRICAL SERVICE TO MAINTAIN POWER TO EXISTING NEW GYM BUILDING UNTIL NEW SERVICE CONNECTION IS PROVIDED. FIELD VERIFY EXISTING CONDITIONS PRIOR TO BIDDING.</p> <p>6. PROVIDE TEMPORARY ELECTRICAL SERVICE TO MAINTAIN POWER TO EXISTING BATHROOM BUILDING. FIELD VERIFY EXISTING CONDITIONS PRIOR TO BIDDING.</p> <p>7. EXISTING UNDERGROUND ELECTRICAL SERVICE AND PANEL AT GARAGE BUILDING SHALL BE REMOVED.</p> <p>8. EXISTING OVERHEAD ELECTRICAL SERVICE SHALL REMAIN.</p> <p>9. EXISTING FREEZER TO BE REMOVED AND RELOCATED TO ACCOMMODATE NEW CONSTRUCTION. REFER TO SHEET ES102 FOR ADDITIONAL INFORMATION.</p> <p>10. EXISTING UNDERGROUND SERVICE TO BE REMOVED. PROVIDE TEMPORARY ELECTRICAL SERVICE TO MAINTAIN POWER TO EXISTING OLD GYM BUILDING UNTIL NEW SERVICE CONNECTION IS PROVIDED. FIELD VERIFY EXISTING CONDITIONS PRIOR TO BIDDING.</p>

ADDITIONS AND RENOVATIONS TO THE
GORDON I.S.D. CAMPUS
 FOR GORDON I.S.D.
 112 RUSK STREET
 GORDON, TEXAS 76453

DRAWN BY: FINCHER

DATE: 28 JULY 2022

REVISIONS		
NO.	DESCRIPTION	DATE

PROJECT NO.
20864.00

SHEET NO.
ES101

© HPA INC.

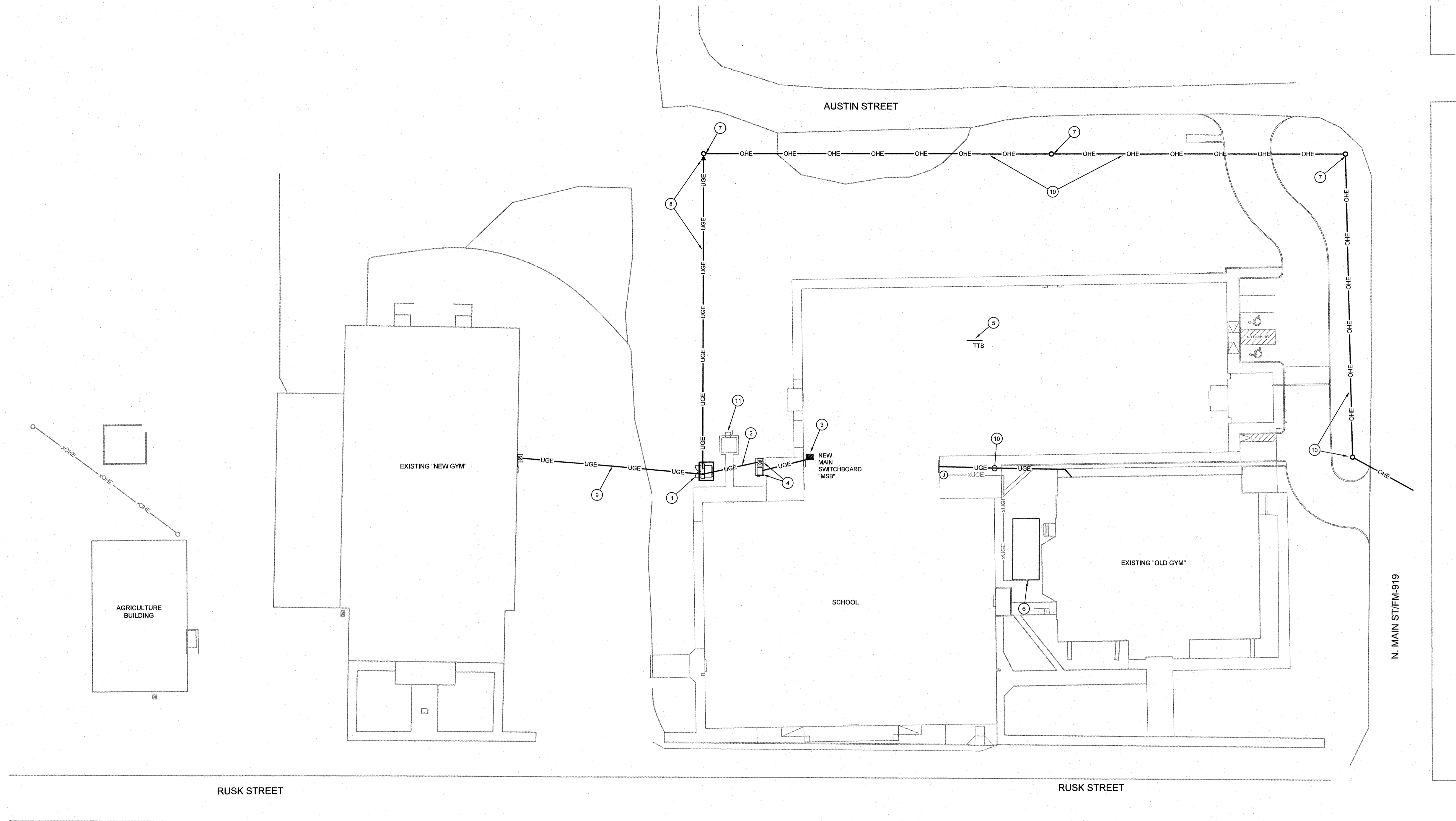

SITE PLAN - ELECTRICAL

SCALE: 1" = 30'-0"

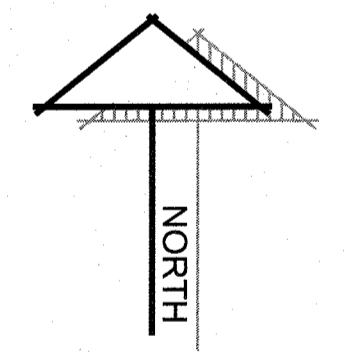

GENERAL NOTES	KEYED NOTES
<p>A. VERIFY ALL ELECTRICAL INSTALLATIONS WITH LOCAL CODES AND CITY ORDINANCES PRIOR TO INSTALLATION.</p> <p>B. COORDINATE WITH THE UTILITY SERVICE PROVIDERS FOR ALL REQUIREMENTS FOR DELIVERING POWER AND COMMUNICATION SERVICE TO THE NEW BUILDING.</p> <p>C. CONTRACTOR SHALL VERIFY LOCATION OF ALL UNDERGROUND UTILITIES PRIOR TO ANY EARTH WORK.</p>	<p>1. NEW 120V/208V, 3Ø, 4W PAD MOUNTED TRANSFORMER BY UTILITY COMPANY. PROVIDE CONCRETE PAD, EARTHWORK AND CONDUIT AS DIRECTED BY UTILITY COMPANY.</p> <p>2. NEW UNDERGROUND SERVICE ENTRANCE TO PAD MOUNTED SWITCHGEAR. REFER TO ELECTRICAL RISER DIAGRAM.</p> <p>3. NEW MAIN SWITCHBOARD "MSB". REFER TO ELECTRICAL RISER DIAGRAM.</p> <p>4. MAIN DISCONNECT, CT CABINET AND KWH METER. REFER TO ELECTRICAL RISER DIAGRAM.</p> <p>5. LOCATION OF TELEPHONE/DATA BACKBOARD. EXTEND EXISTING FIBER OPTICS AND COMMUNICATION SERVICE TO NEW LAN ROOM/TTB. COORDINATE WITH UTILITY PROVIDERS PRIOR TO BID.</p> <p>6. EXTEND AND CONNECT EXISTING BATHROOM BUILDING TO NEW MAIN DISTRIBUTION PANEL "MSB". REFER TO PANEL SCHEDULE FOR ADDITIONAL INFORMATION.</p> <p>7. UTILITY PRIMARY POLE BY UTILITY COMPANY. COORDINATE REQUIREMENTS WITH UTILITY COMPANY.</p> <p>8. UNDERGROUND PRIMARY BY UTILITY COMPANY. PROVIDE EARTHWORK FOR PRIMARY AS REQUIRED BY UTILITY COMPANY.</p> <p>9. NEW ELECTRICAL SERVICE TO EXISTING NEW GYM BUILDING. REFER TO ELECTRICAL RISER DIAGRAM FOR ADDITIONAL INFORMATION.</p> <p>10. NEW OVERHEAD PRIMARY ELECTRIC SERVICE AND POLES BY UTILITY COMPANY. COORDINATE REQUIREMENTS WITH UTILITY COMPANY.</p> <p>11. NEW LOCATION OF EXISTING FREEZER. CONTRACTOR SHALL EXTEND AND CONNECT EXISTING CIRCUIT FOR TEMPORARY CONNECTION AS REQUIRED BY NEC. COORDINATE REQUIREMENTS WITH ARCHITECT AND OWNER. FIELD VERIFY EXISTING CONDITIONS.</p> <p>12. NEW ELECTRICAL SERVICE TO EXISTING OLD GYM BUILDING. REFER TO ELECTRICAL RISER DIAGRAM FOR ADDITIONAL INFORMATION.</p>



CLINTON W. FARRIS #28983
DATE SIGNED: 1-28-22

HPA
ESTABLISHED 1962
ARCHITECTS PROGRAMMERS PLANNERS
4724 OLD JACKSBORO HIGHWAY
WICHITA FALLS, TEXAS 76302-3599
VOICE: 940.767.1421 FAX: 940.397.0273
WEB: www.hpa1962.com

FINCHER
ENGINEERING, LLC
FINCHER ENGINEERING, LLC
TX FIRM #F-16408
5821 114TH ST., SUITE 100
LUBBOCK, TX 79424
PH: 806-701-5109
WWW.FINCHERENG.COM

ADDITIONS AND RENOVATIONS TO THE
GORDON I.S.D. CAMPUS
FOR GORDON I.S.D.

112 RUSK STREET
GORDON, TEXAS 76453

DRAWN BY: FINCHER
DATE: 28 JULY 2022

REVISIONS		
NO.	DESCRIPTION	DATE

PROJECT NO.
20864.00

SHEET NO.
ES102

© HPA INC.

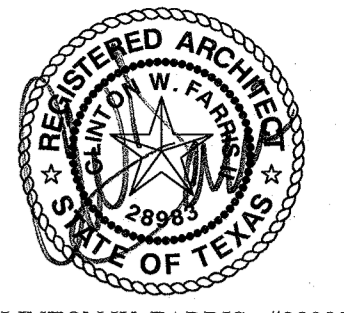
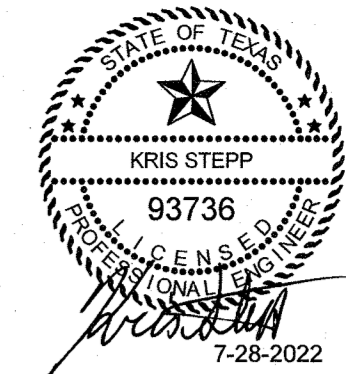

CLINTON W. FARRIS #28983
DATE SIGNED: 4-28-22

HPA
ESTABLISHED 1962
ARCHITECTS - PROGRAMMERS - PLANNERS
4724 OLD JACKSBORO HIGHWAY
WICHITA FALLS, TEXAS 76302-3599
VOICE: 840.767.1421 FAX: 840.397.0273
WEB: www.hpa1962.com

FINCHER
ENGINEERING, LLC
FINCHER ENGINEERING, LLC
TX FIRM #F-16408
5621 114TH ST., SUITE 100
LUBBOCK, TX 79424
PH: 806-701-5100
WWW.FINCHERENG.COM

GENERAL NOTES	KEYED NOTES
<p>A. ALL ELECTRICAL DEVICES SHOWN DASHED, OR ON DASHED WALLS, ALONG WITH ALL WIRING AND CONDUIT ASSOCIATED WITH DEVICE SHALL BE REMOVED BACK TO POINT OF ORIGIN UNLESS NOTED OTHERWISE.</p> <p>B. CONTRACTOR SHALL VERIFY LOCATION OF ALL UNDERGROUND UTILITIES PRIOR TO EARTHWORK.</p> <p>C. VERIFY EXACT LOCATION OF ALL DEVICES AND CONDUIT TO REMAIN.</p> <p>D. THE ELECTRICAL CONTRACTOR SHALL VERIFY ALL PANEL CONNECTIONS PRIOR TO PANEL REMOVAL/RELOCATION. THE CONTRACTOR IS RESPONSIBLE FOR EXTENDING AND CONNECTING ALL FEEDER BRANCH CIRCUITS/CONDUITS TO REMAIN. CONTRACTOR SHALL SIZE CONDUCTOR/CONDUIT IN ACCORDANCE WITH NEC.</p> <p>E. ALL DOWNSTREAM DEVICES NOT BEING REMOVED AS PART OF THIS PROJECT SHALL REMAIN ACTIVE. THIS INCLUDES BUT NOT LIMITED TO RECEPTACLES, LIGHTS, FIRE ALARM, DATA, AND COMMUNICATION OUTLETS/WIRING.</p> <p>F. ALL POWER AND COMMUNICATIONS OUTAGES SHALL BE COORDINATED WITH OWNER AND ARCHITECT PRIOR TO OUTAGE. PROVIDE TEMPORARY CONNECTIONS (POWER AND COMMUNICATION WIRING) TO EQUIPMENT TO MAINTAIN SERVICE DURING CONSTRUCTION AS REQUIRED.</p>	<p>1. EXISTING PANEL MAIN DISTRIBUTION PANEL (MDP) SHALL BE REMOVED AND RELOCATED FOR TEMPORARY ELECTRIC SERVICE TO EXISTING SCHOOL BUILDING, EXISTING GYM BUILDING, EXISTING OLD GYM BUILDING AND BATHROOM BUILDING. EXTEND TEMPORARY SERVICE TO EXISTING BUILDING PANEL TO REMAIN AS REQUIRED BY NEC. PROVIDE CONDUITS AND CONDUCTORS AS NEEDED FOR ALL FEEDER AND BRANCH CIRCUITS TO REMAIN. FIELD VERIFY EXISTING CONDITIONS PRIOR TO BIDDING. COORDINATE LOCATION TEMPORARY MAIN DISTRIBUTION PANEL WITH ARCHITECT AND OWNER.</p> <p>2. EXISTING DISTRIBUTION PANEL ALL ASSOCIATED PANELS IN THIS AREA SHALL REMAIN ACTIVE. COORDINATE PHASING REQUIREMENTS WITH ARCHITECT. PROVIDE TEMPORARY CONNECTION TO MAINTAIN POWER TO THIS SECTION OF THE BUILDING. FIELD VERIFY EXISTING CONDITIONS PRIOR TO BIDDING.</p> <p>3. ALL EXISTING ELECTRICAL PANELS, LIGHTS AND DEVICES SHALL REMAIN ACTIVE FOR TEMPORARY USE DURING CONSTRUCTION. COORDINATE PHASING REQUIREMENTS WITH ARCHITECT. FIELD VERIFY EXISTING CONDITIONS PRIOR TO BIDDING.</p> <p>4. ALL EXISTING ELECTRICAL PANELS, LIGHTS, DEVICES AND ALL ASSOCIATED WIRING SHALL BE REMOVED IN THIS AREA TO ACCOMMODATE DEMOLITION. COORDINATE PHASING REQUIREMENTS WITH ARCHITECT.</p>

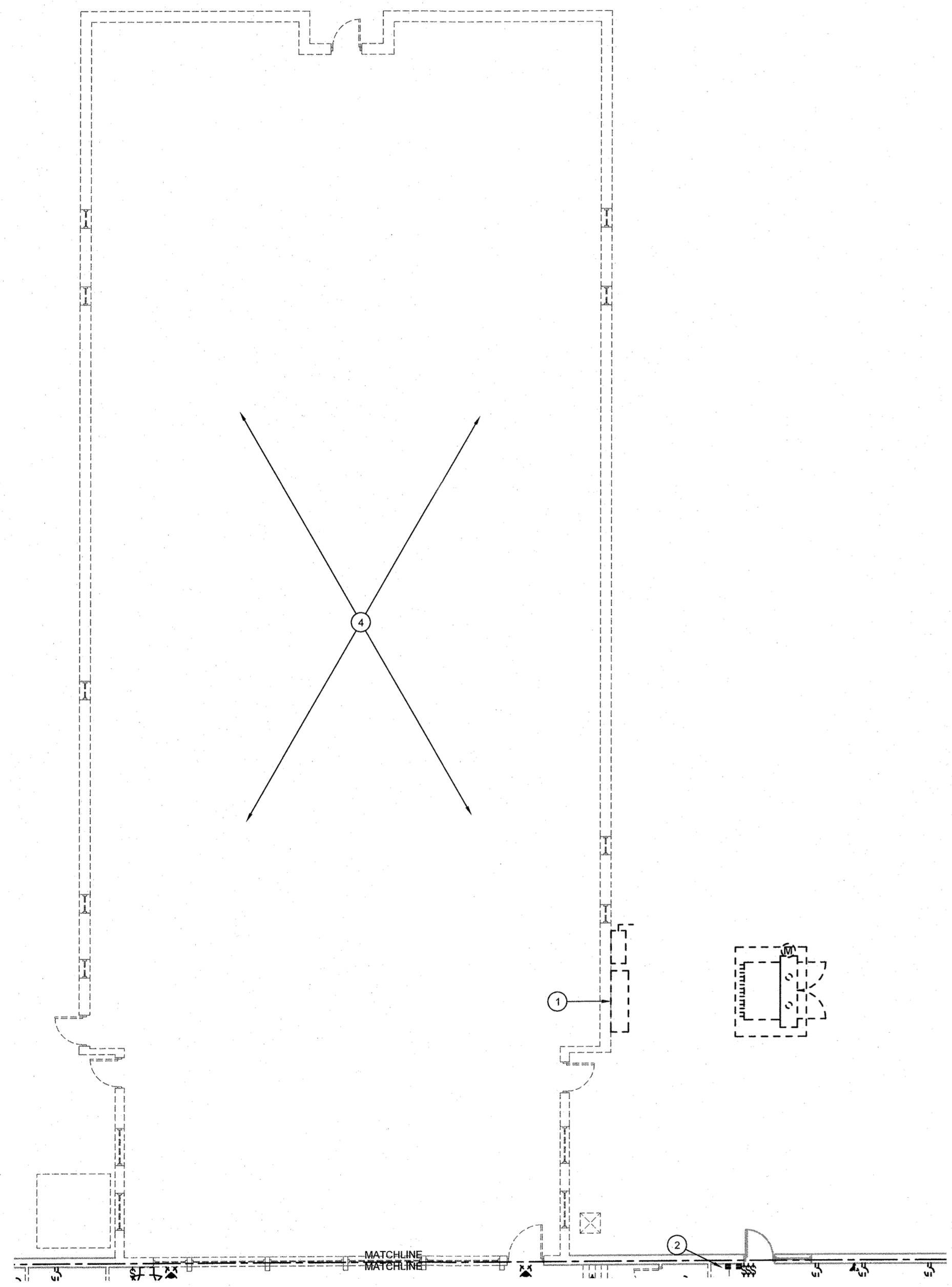

FLOOR PLAN - NORTH
ELECTRICAL DEMOLITION

SCALE: 3/32" = 1'-0"

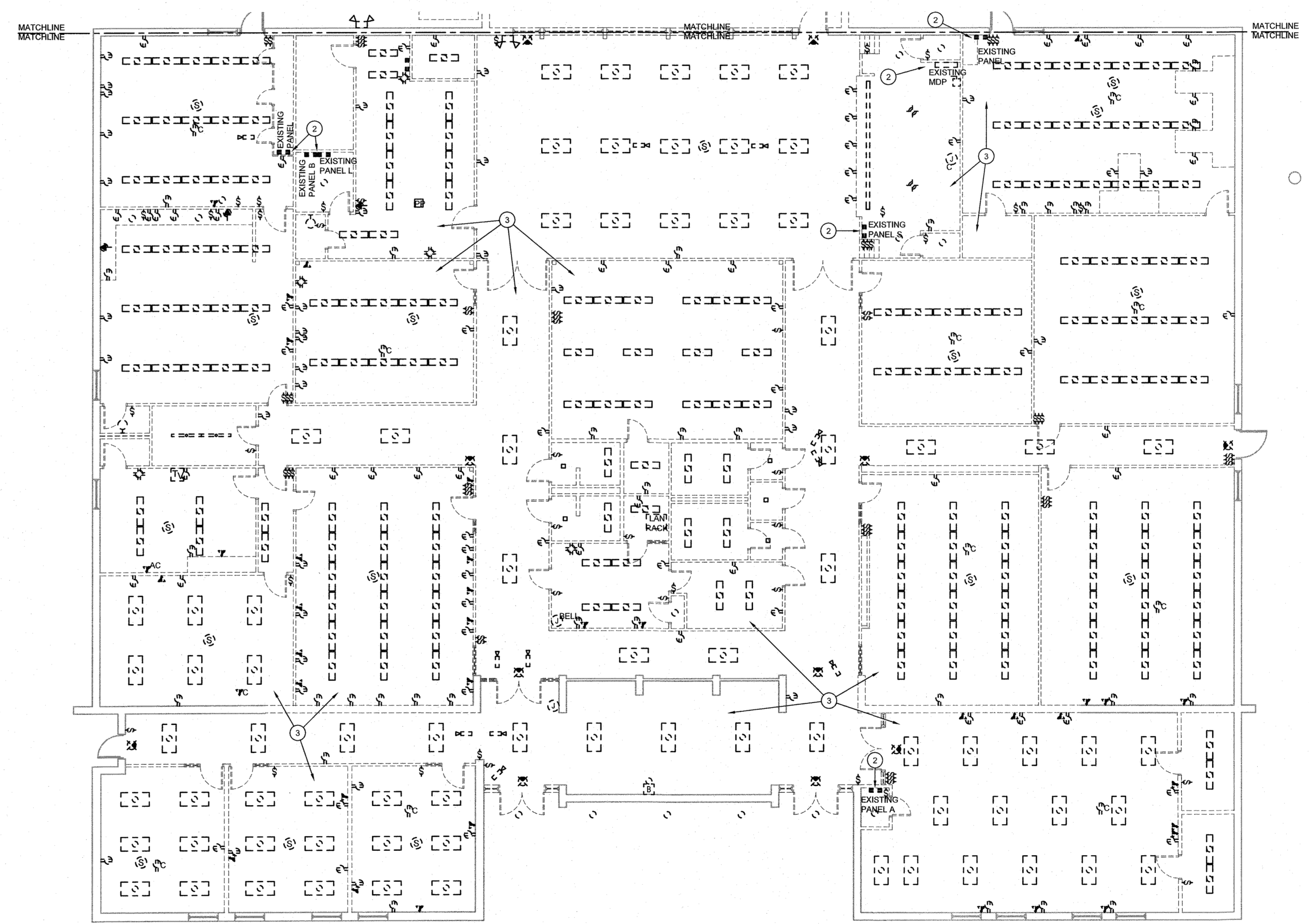
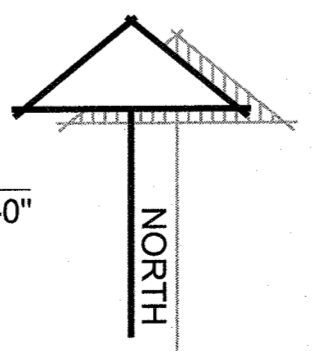

FLOOR PLAN - SOUTH - ELECTRICAL DEMOLITION

SCALE: 3/32" = 1'-0"

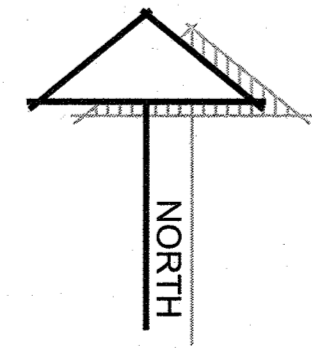

ADDITIONS AND RENOVATIONS TO THE
GORDON I.S.D. CAMPUS
 FOR GORDON I.S.D.
 112 RUSK STREET
 GORDON, TEXAS 76453

DRAWN BY: FINCHER		
DATE: 28 JULY 2022		
REVISIONS		
NO.	DESCRIPTION	DATE
PROJECT NO. 20864.00		
SHEET NO. ED101		

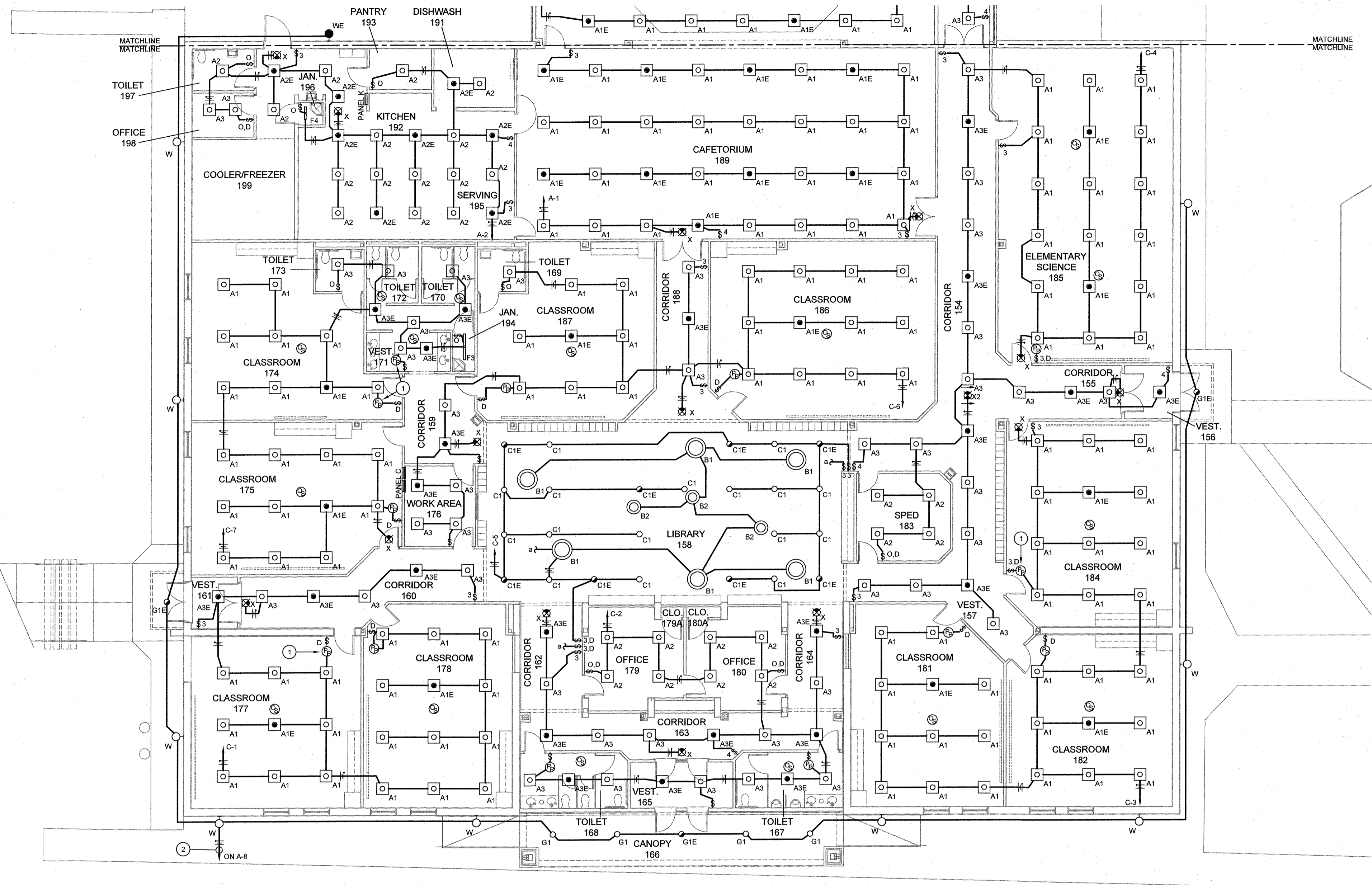

FLOOR PLAN - ELEMENTARY - LIGHTING

SCALE: 3/32" = 1'-0"

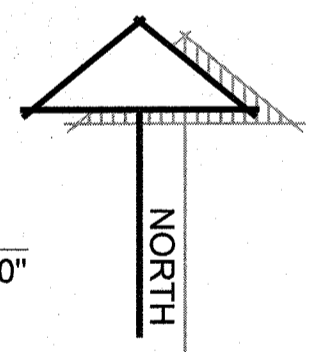

GENERAL NOTES	KEYED NOTES
<p>A. VERIFY EXACT LOCATION OF ALL ELECTRICAL EQUIPMENT WITH OWNER AND ARCHITECT PRIOR TO INSTALLATION.</p> <p>B. VERIFY ALL ELECTRICAL INSTALLATIONS WITH LOCAL CODES AND CITY ORDINANCES PRIOR TO INSTALLATION.</p> <p>C. VERIFY AND COORDINATE EXACT LOCATION OF ALL LIGHT FIXTURE LOCATIONS AND MOUNTING HEIGHTS WITH ARCHITECTURAL REFLECTED CEILING PLAN.</p> <p>D. ANY OUTLET, SWITCH, RECEPTACLE, FIXTURE OR PANEL MAY BE RELOCATED WITHIN A TEN (10) FOOT RADIUS OF THE INDICATED LOCATION WITHOUT ADDITIONAL CHARGE TO OWNER.</p> <p>E. PROVIDE AN UN-SWITCHED HOT (BALLAST/DRIVER) TO ALL EMERGENCY FIXTURES ROUTED THRU LIGHTING CONTROLS TO PROVIDE EMERGENCY OPERATION.</p> <p>F. PROVIDE DEDICATED NEUTRAL WIRE FOR EACH 120V CIRCUIT BREAKER.</p> <p>G. LIGHTING CONTROL WIRING SHALL BE ROUTED IN SEPARATE CONDUIT/PATHWAY FROM POWER WIRING.</p>	<p>1. POWER PACK TO OPERATE OCCUPANCY SENSOR AND DIMMER SWITCH. MOUNT POWER PACK ABOVE CEILING. (TYPICAL)</p> <p>2. ROUTE CIRCUIT THROUGH EXTERIOR LIGHTING CONTROLS.</p>

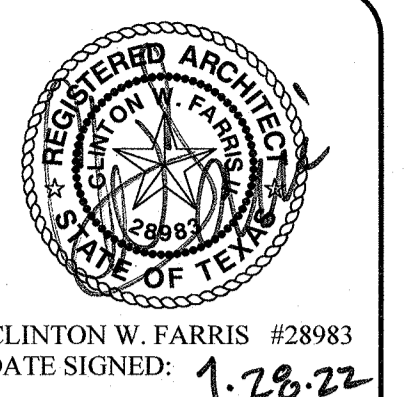

HPA
 ESTABLISHED 1962
 ARCHITECTS - PROGRAMMERS - PLANNERS
 4724 OLD JACKSBORO HIGHWAY
 WICHITA FALLS, TEXAS 76302-3599
 VOICE: 940.767.1421 FAX: 940.397.0273
 WEB: www.hpa1962.com

FINCHER
 ENGINEERING, LLC
 FINCHER ENGINEERING, LLC
 TX FIRM #F-16408
 5621 114TH ST., SUITE 100
 LUBBOCK, TX 79424
 PH: 806-701-5109
 WWW.FINCHERENG.COM

ADDITIONS AND RENOVATIONS TO THE
GORDON I.S.D. CAMPUS
 FOR GORDON I.S.D.
 112 RUSK STREET
 GORDON, TEXAS 76453

DRAWN BY: FINCHER

DATE: 28 JULY 2022

REVISIONS		
NO.	DESCRIPTION	DATE

PROJECT NO.
20864.00

SHEET NO.
E101

© HPA INC.

GENERAL NOTES	KEYED NOTES
A. VERIFY EXACT LOCATION OF ALL ELECTRICAL EQUIPMENT WITH OWNER AND ARCHITECT PRIOR TO INSTALLATION.	1. POWER PACK TO OPERATE OCCUPANCY SENSOR AND DIMMER SWITCH. MOUNT POWER PACK ABOVE CEILING. (TYPICAL)
B. VERIFY ALL ELECTRICAL INSTALLATIONS WITH LOCAL CODES AND CITY ORDINANCES PRIOR TO INSTALLATION.	2. ROUTE CIRCUIT THROUGH EXTERIOR LIGHTING CONTROLS.
C. VERIFY AND COORDINATE EXACT LOCATION OF ALL LIGHT FIXTURE LOCATIONS AND MOUNTING HEIGHTS WITH ARCHITECTURAL REFLECTED CEILING PLAN.	3. EXTEND AND CONNECT TO LIGHT FIXTURES AN MEZZANINE. COORDINATE LOCATION OF SWITCH WITH ARCHITECT AND OWNER.
D. ANY OUTLET, SWITCH, RECEPTACLE, FIXTURE OR PANEL MAY BE RELOCATED WITHIN A TEN (10) FOOT RADIUS OF THE INDICATED LOCATION WITHOUT ADDITIONAL CHARGE TO OWNER.	
E. PROVIDE AN UN-SWITCHED HOT (BALLAST/DRIVER) TO ALL EMERGENCY FIXTURES ROUTED THRU LIGHTING CONTROLS TO PROVIDE EMERGENCY OPERATION.	
F. PROVIDE DEDICATED NEUTRAL WIRE FOR EACH 120V CIRCUIT BREAKER.	
G. LIGHTING CONTROL WIRING SHALL BE ROUTED IN SEPARATE CONDUIT/PATHWAY FROM POWER WIRING.	

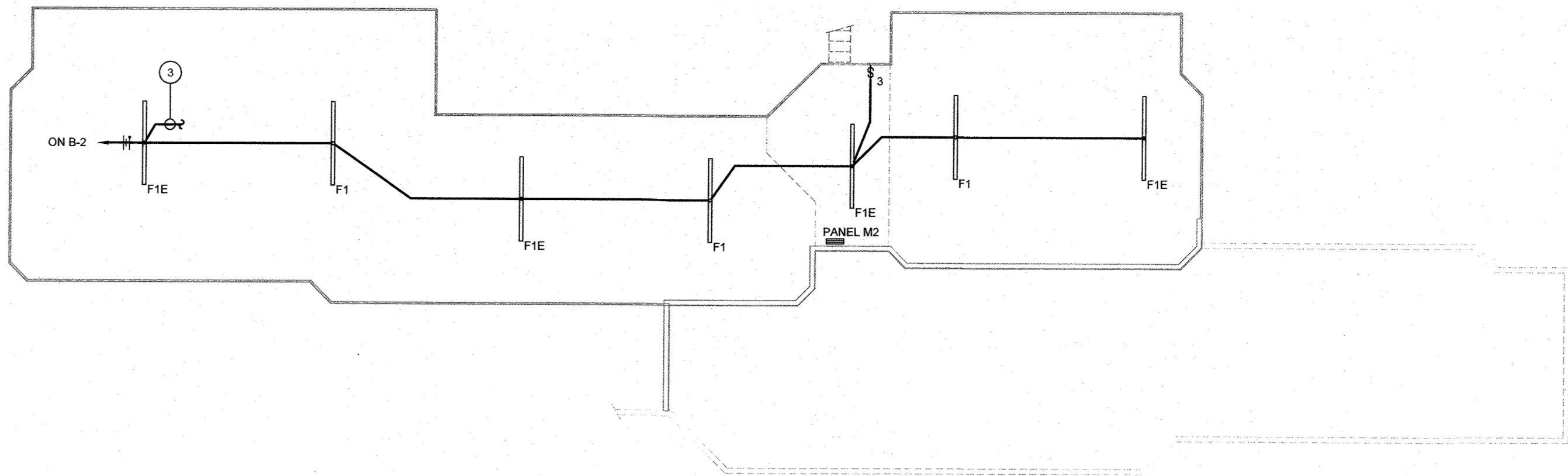

FLOOR PLAN - MEZZANINE - LIGHTING

SCALE: 3/32" = 1'-0"

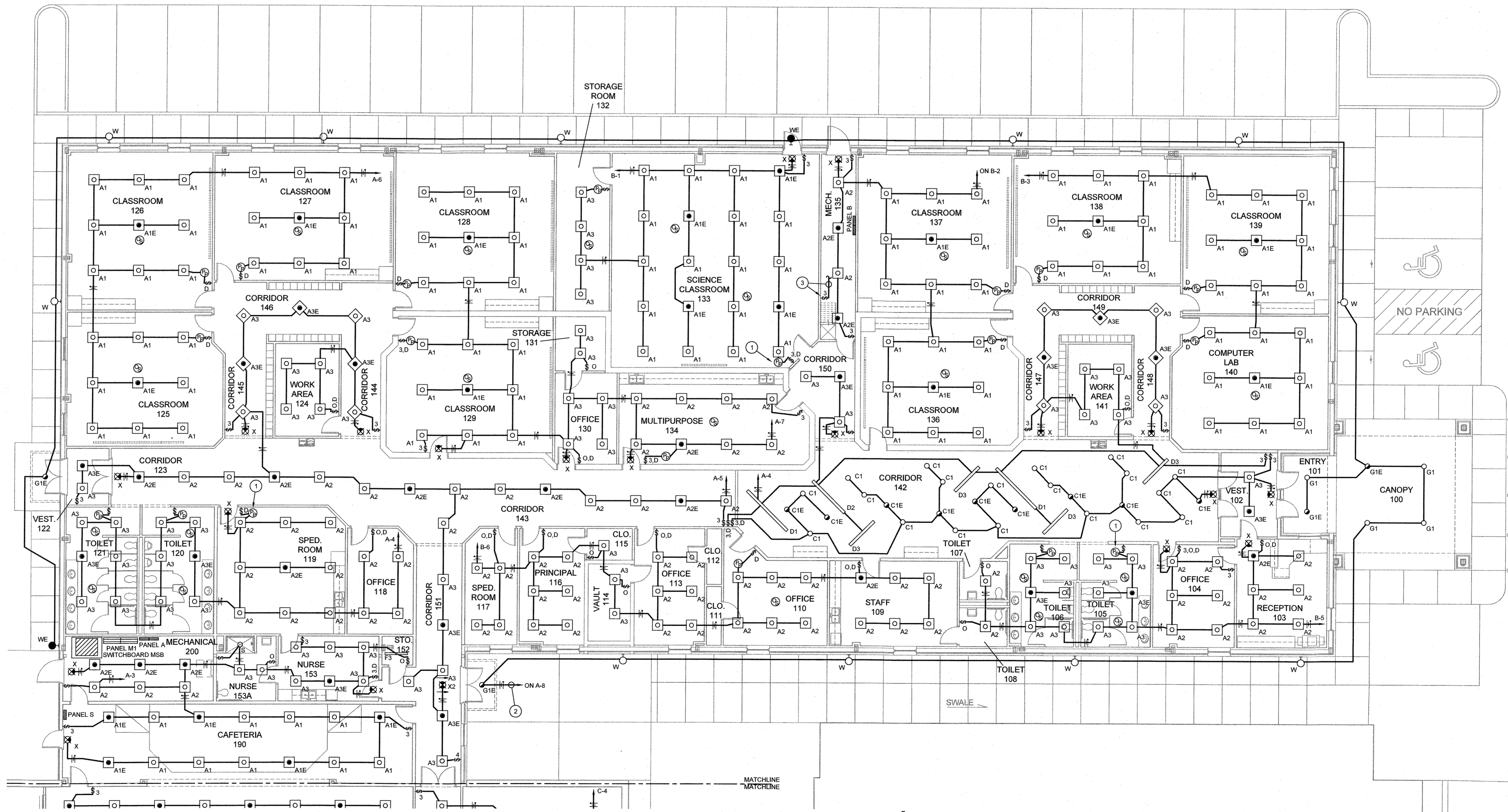
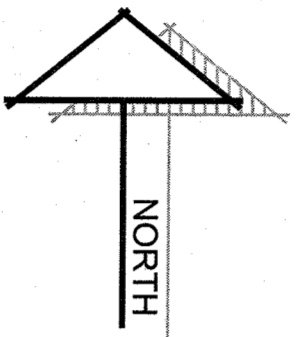

FLOOR PLAN - SECONDARY - LIGHTING

SCALE: 3/32" = 1'-0"

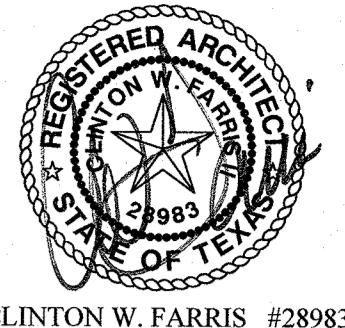
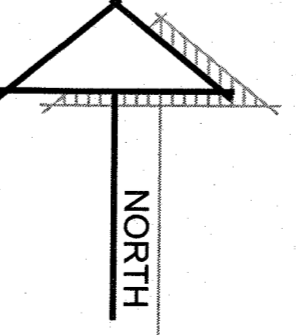

H&P
 ESTABLISHED 1962
 ARCHITECTS - PROGRAMMERS - PLANNERS
 4724 OLD JACKSBORO HIGHWAY
 WICHITA FALLS, TEXAS 76302-3599
 VOICE: 940.767.1421 FAX: 940.397.0273
 WEB: www.hp1962.com

FINCHER
 ENGINEERING, LLC
 FINCHER ENGINEERING, LLC
 TX FIRM #F-16408
 5621 114TH ST., SUITE 100
 LUBBOCK, TX 79424
 PH: 806-701-5109
 WWW.FINCHERENG.COM

ADDITIONS AND RENOVATIONS TO THE
GORDON I.S.D. CAMPUS
 FOR GORDON I.S.D.
 112 RUSK STREET
 GORDON, TEXAS 76453

DRAWN BY: FINCHER
 DATE: 28 JULY 2022

REVISIONS		
NO.	DESCRIPTION	DATE

PROJECT NO.
20864.00

SHEET NO.
E102

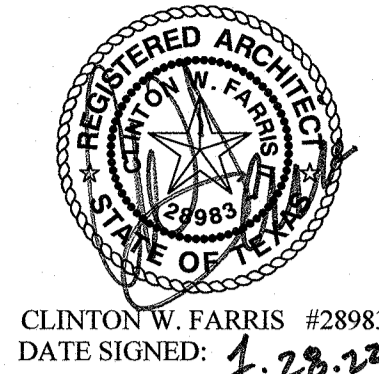
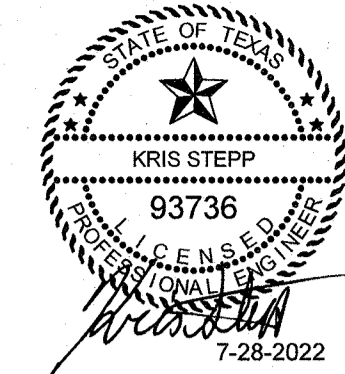

HPA
 ESTABLISHED 1962
 ARCHITECTS - PROGRAMMERS - PLANNERS
 4724 OLD JACKSBORO HIGHWAY
 WICHTA FALLS, TEXAS 76302-3599
 VOICE: 940.767.1421 FAX: 940.397.0273
 WEB: www.hpa1962.com

FINCHER
 ENGINEERING, LLC
 FINCHER ENGINEERING, LLC
 TX FIRM #F-16408
 5621 114TH ST., SUITE 100
 LUBBOCK, TX 79424
 PH: 806-701-5109
 WWW.FINCHERENG.COM

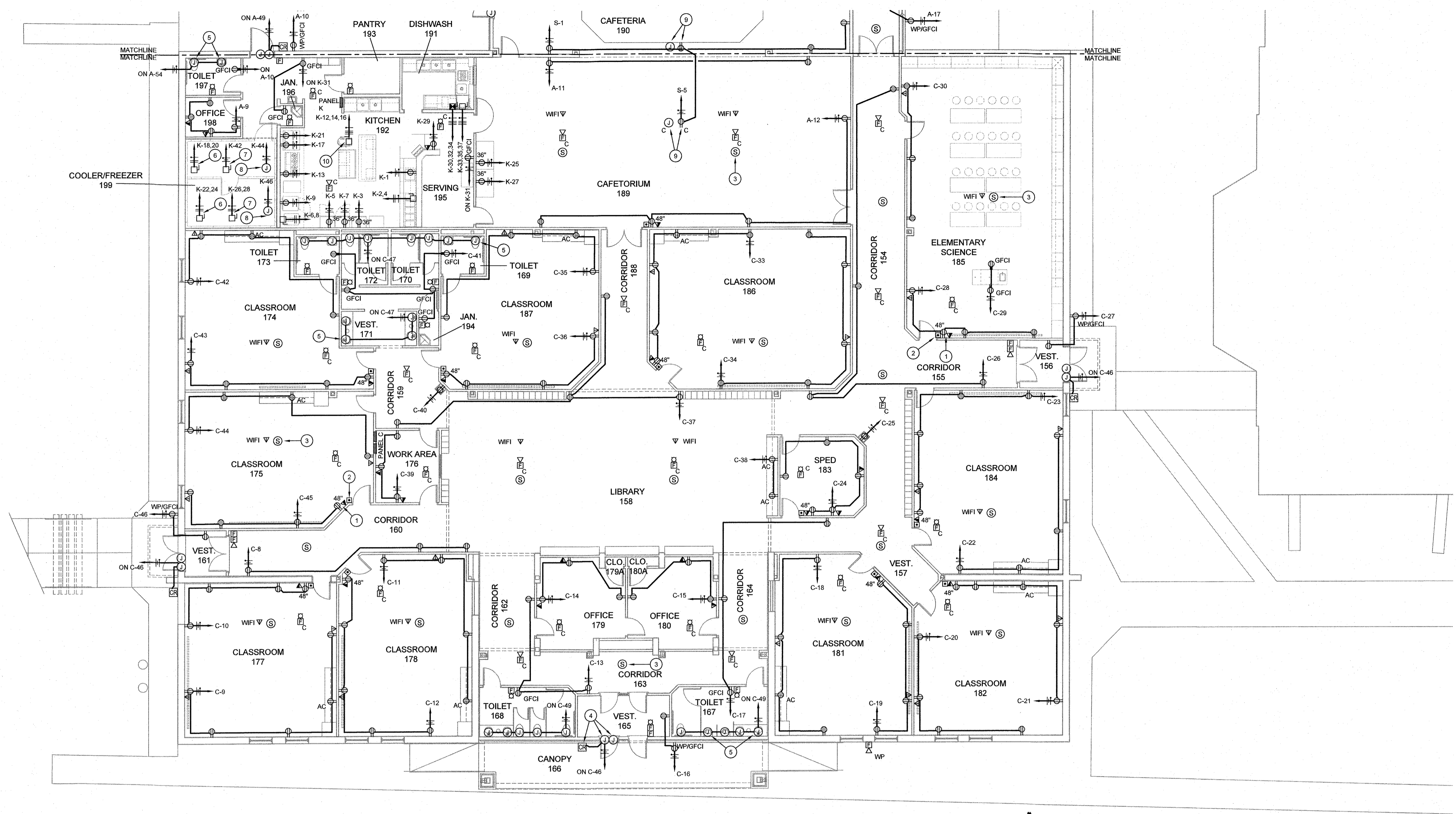

FLOOR PLAN - ELEMENTARY - POWER/COMMUNICATIONS
 SCALE: 3/32" = 1'-0"
 NORTH

GENERAL NOTES		KEYED NOTES	
A. VERIFY ALL ELECTRICAL INSTALLATIONS WITH LOCAL CODES AND CITY ORDINANCES PRIOR TO INSTALLATION.	J. WHERE GFCI PROTECTION IS REQUIRED BY CODE AND CONNECTION IS LOCATED BEHIND EQUIPMENT, CONTRACTOR SHALL PROVIDE GFCI CIRCUIT BREAKER IN LIEU OF GFCI OUTLET.	1. POWER AND COMMUNICATION OUTLET FOR CLASSROOM PHONE. PHONE PROVIDED AND INSTALLED BY OWNER. (TYPICAL)	
B. IT IS ASSUMED THAT ANY OUTLET, SWITCH, RECEPTACLE, FIXTURE OR PANEL MAY BE RELOCATED WITHIN A TEN (10) FOOT RADIUS OF THE INDICATED LOCATION WITHOUT ADDITIONAL CHARGE TO THE OWNER.	K. IN COMMERCIAL KITCHEN, PROVIDE GFI CIRCUIT BREAKERS AS INDICATED IN NEC ARTICLE 210.8(B)	2. PA SYSTEM CALL BUTTON. EXTEND AND CONNECT TO PUBLIC ADDRESS SYSTEM AS REQUIRED. COORDINATE CONNECTION REQUIREMENTS WITH MANUFACTURER. (TYPICAL)	
C. THE ELECTRICAL CONTRACTOR SHALL FIELD VERIFY EXACT POWER REQUIREMENTS FOR OWNER FURNISHED EQUIPMENT PRIOR TO ROUGH-IN. TERMINATE AS DIRECTED BY EQUIPMENT NAME PLATES. COORDINATE EXACT LOCATION FOR INSTALLATIONS WITH OWNER PRIOR TO ROUGH-IN. NOTIFY ENGINEER IF ALTERNATE POWER IS REQUIRED.	L. ALL RECEPTACLES IN AREAS SPECIFIED SHALL BE TAMPER RESISTANT INCLUDING: HOTEL GUEST ROOMS, DWELLING UNITS, CHILD CARE FACILITIES, PRESCHOOL/ELEMENTARY EDUCATION FACILITIES, MEDICAL CLINICS, MEDICAL OFFICES, MEDICAL OUTPATIENT FACILITIES, GYMNASIUMS, SKATING RINKS, AND AUDITORIUMS, AND DORMITORIES AS REQUIRED BY NEC ARTICLE 406.12	3. NEW RECESSED PA SPEAKER. PROVIDE BACK BOX FOR SPEAKER AS REQUIRED. EXTEND AND CONNECT TO PUBLIC ADDRESS SYSTEM. COORDINATE CONNECTION REQUIREMENTS WITH MANUFACTURER. (TYPICAL)	
D. VERIFY EXACT LOCATION OF ALL MECHANICAL EQUIPMENT AND TEMPERATURE CONTROLS WITH MECHANICAL PLANS. PROVIDE 1" CONDUIT AT EACH THERMOSTAT. REFER TO MECHANICAL PLANS FOR LOCATIONS.	M. PROVIDE LOCAL DISCONNECTS FOR ALL EQUIPMENT THAT IS PROVIDED WITH DIRECT CONNECTION (NON-PLUG RECEPTACLE). ANY DISCONNECTS THAT ARE PROVIDED IN AREAS SUBJECT TO MOISTURE (I.E. DISHWASHING AREAS) SHALL BE STAINLESS STEEL AND RATED FOR NEMA 4X.	4. EXTERIOR DOOR ACCESS CONTROL POWER AND COMMUNICATION CONDUIT. COORDINATE REQUIREMENTS WITH SECURITY COMPANY AND DOOR HARDWARE CONTRACTOR. (TYPICAL)	
E. PROVIDE DEDICATED NEUTRAL WIRE FOR EACH 120V CIRCUIT BREAKER.	N. PROVIDE 120V POWER FOR EACH HOOD SUPPRESSION SYSTEM AND EXTEND AND CONNECT TO THE BUILDING FACP UPON ACTIVATION. PROVIDE FOR ALL INTERLOCKING REQUIREMENTS TO ACCOMPLISH THE CONTROLS SEQUENCE INDICATED.	5. 120V INFRARED PLUMBING SENSOR. COORDINATE CONNECTION REQUIREMENTS AND LOCATION WITH PLUMBING CONTRACTOR AND MANUFACTURER. (TYPICAL)	
F. PROVIDE MOTOR RATED SWITCHES FOR EACH 120V HVAC CONNECTIONS. OVERLOADS SHALL MATCH MOTOR RATING.	O. ALL SINGLE PHASE 120, 208V RECEPTACLES RATED AT 50 AMPS OR LESS AND ALL THREE PHASE 120/208V RECEPTACLES RATED 100 AMPS OR LESS SHALL BE A GFCI TYPE RECEPTACLE OR GFCI CIRCUIT BREAKER AS REQUIRED BY NEC ARTICLE 210.8.(B)	6. WALK-IN COOLER/FREEZER CONDENSING UNIT TO BE MOUNTED ON ROOF. COORDINATE CONNECTION REQUIREMENTS WITH MANUFACTURER.	
G. CONTRACTOR SHALL PROVIDE NEMA 3R DISCONNECT SWITCHES FOR ALL EXTERIOR HVAC EQUIPMENT. INTERIOR DRY LOCATION DISCONNECT ENCLOSURES SHALL BE RATED NEMA 1.	P. ALL FIRE ALARM WIRING SHALL BE INSTALLED IN CONDUIT.	7. WALK-IN COOLER/FREEZER EVAPORATOR UNIT TO BE MOUNTED ON ROOF. COORDINATE CONNECTION REQUIREMENTS WITH MANUFACTURER.	
H. ALL CONDUITS SERVING ROOF-MOUNTED EQUIPMENT SHALL BE EXTENDED INSIDE THE UNIT CURBS TO AVOID ADDITIONAL PITCHPANS. ALL EXTERIOR CONDUIT SHALL BE RIGID GALVANIZED STEEL OR LIQUID TIGHT FLEXIBLE CONDUIT AS SPECIFIED.	Q. PROVIDE INTERFACE CONNECTION FOR ALL KITCHEN HOODS TO THE NEW FIRE ALARM CONTROL PANEL TO INITIATE GENERAL ALARM UPON ACTIVATION OF ANY HOOD SUPPRESSION SYSTEM. PROVIDE ALL NECESSARY INTERFACE RELAYS AND COORDINATE FOR 120 VOLT POWER REQUIREMENTS AS REQUIRED.	8. JUNCTION BOX TO SERVE WALK-IN COOLER/FREEZER LIGHTS AND CONTROLS. COORDINATE CONNECTION REQUIREMENTS WITH MANUFACTURER.	
I. DATA/TELEPHONE/TV OUTLETS SHALL BE INSTALLED WITH 3/4" CONDUIT EXTENDED TO AN ACCESSIBLE POINT ABOVE CEILING AND PROVIDED WITH PULL STRING. COORDINATE ALL TELEPHONE, TV AND DATA LOCATIONS WITH OWNER. PROVIDE INSULATED BUSHING ON BOTH ENDS OF CONDUIT.		9. POWER AND COMMUNICATION PATHWAY FOR OWNER PROVIDED PROJECTOR. COMMUNICATION CONDUIT SHALL BE 1-1/4". COORDINATE ROUTING AND LOCATION OF OUTLETS WITH OWNER AND ARCHITECT.	
		10. COORDINATE ROUTING OF CONDUIT WITH OWNER AND ARCHITECT.	

ADDITIONS AND RENOVATIONS TO THE
GORDON I.S.D. CAMPUS
 FOR GORDON I.S.D.
 112 RUSK STREET
 GORDON, TEXAS 76453

DRAWN BY: FINCHER		
DATE: 28 JULY 2022		
REVISIONS		
NO.	DESCRIPTION	DATE
PROJECT NO. 20864.00		
SHEET NO. E201		